

# RAIDON

## iT4300 系列快速安裝導引

### 產品示意圖與配件表

前視圖

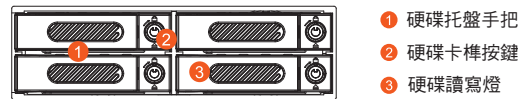

背視圖

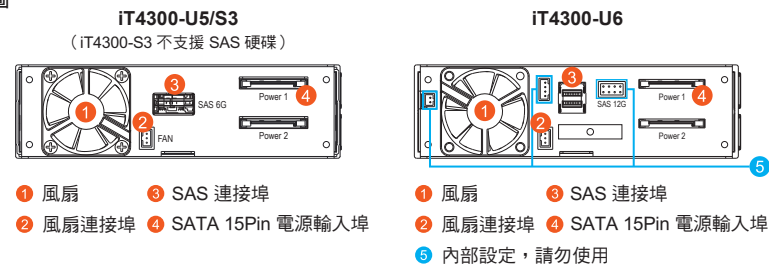

打開包裝外盒後，包裝內容應包含下列組件：

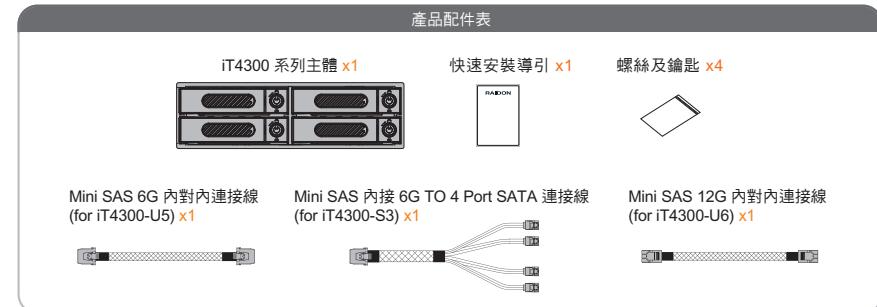

請先確認相關配件與產品本身是否有受損或是缺少配件，若有任何疑問，請與您的經銷商或業務人員聯絡。

v1.3 (Dec. 2017)

1

## 硬體安裝

請參照下列步驟，完成iT4300系列的硬體安裝：

1. 解開硬碟托盤鎖。

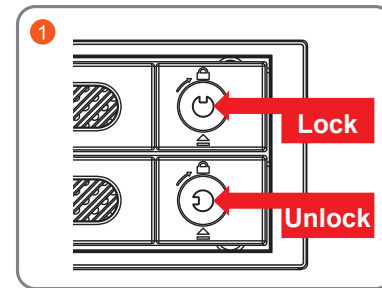

2. 按下硬碟卡榫按鍵。

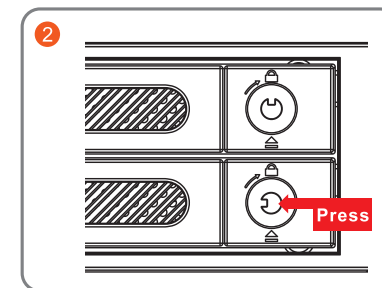

3. 抽出硬碟托盤組。

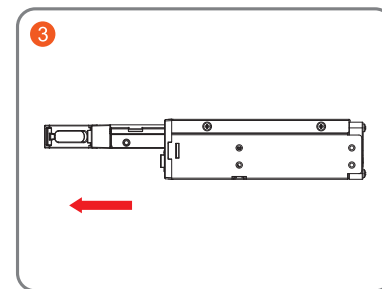

4. 將 2.5 吋硬碟安裝在硬碟托盤上。

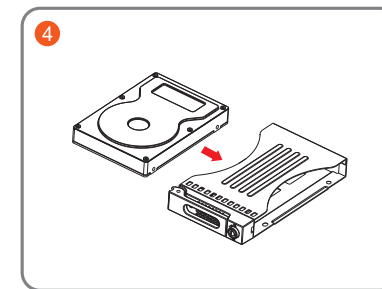

2

5. 鎖上附件包內的螺絲。

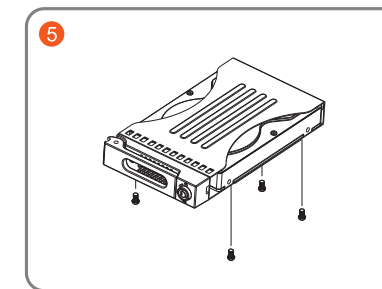

6. 將硬碟托盤安裝回 iT4300 系列產品。

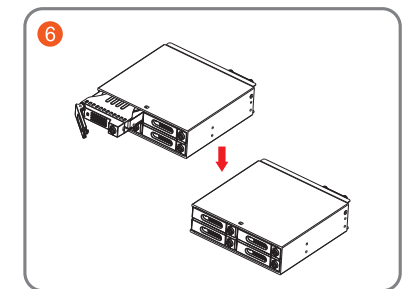

7. 將主體安裝於電腦機殼上的CD-ROM位置，請使用配件零件包的螺絲固定，並連接產品所附的連接線。

**注意事項：**  
請確實將電源線插進正確的位置

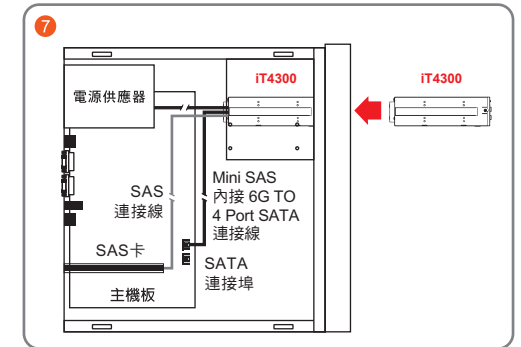

8. 硬體安裝完成。一旦開啟電腦，您的作業系統會自動辨識所裝置好的硬碟。如果您的硬碟是必須被格式化的，請依照電腦的作業系統進行硬碟格式化步驟。當完成硬碟格式化後，硬碟便可以進行資料讀寫。

3

## 燈號說明 (iT4300-U5 / S3)

### 使用SAS硬碟時 (iT4300-U5)

狀態	硬碟燈號	蜂鳴器
硬碟閒置	藍燈 / 紫燈 恆亮 (註)	--
資料存取	紫燈閃爍	--
無硬碟	--	--
風扇故障	--	鳴叫
溫度過高 ( $\geq 55^{\circ}\text{C}$ )	--	鳴叫

註：依據使用的SAS擴充卡會有不同的燈號狀態。

### 使用SATA硬碟時 (iT4300-U5/S3)

狀態	硬碟燈號	蜂鳴器
硬碟閒置	藍燈恆亮	--
資料存取	綠燈閃爍	--
無硬碟	--	--
風扇故障	--	鳴叫
溫度過高 ( $\geq 55^{\circ}\text{C}$ )	--	鳴叫

4

## 燈號說明 (iT4300-U6)

狀態	硬碟燈號	蜂鳴器
硬碟閒置	藍燈恆亮	--
資料存取	藍燈閃爍	--
硬碟移除	紫燈恆亮	鳴叫
風扇故障	藍燈恆亮	鳴叫
溫度過高 ( $\geq 55^{\circ}\text{C}$ )	藍燈恆亮	鳴叫

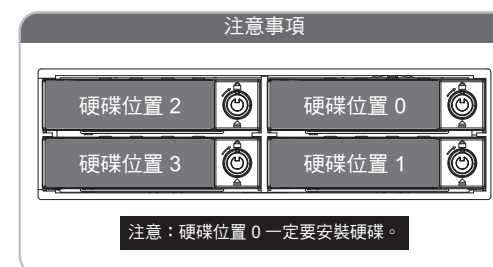

5

## 產品使用注意事項

- 若想得到較佳的使用效能與選購硬碟的便利性，建議使用規格及廠牌相同的 2.5 吋硬碟。
- 請確保使用的硬碟是不含壞軌的，以避免當其中一顆硬碟發生故障時，可能導致系統當機或所有資料遺失。
- iT4300 系列允許裝載使用 SAS 或 SATA 硬碟下，還是建議您先確認您所使用的 mini-SAS 擴充卡是否有向下兼容 SATA 硬碟；另外，其系統處理效能表現將依 mini-SAS 或 SATA 硬碟而異。
- 當您需要關閉或移除 iT4300 系列時，務必透過您所操作的作業系統中執行硬碟安全移除後，方可進行電源關閉的動作。
- 當系統運作時，請勿任意移除任何一顆硬碟，以免導致資料遺失。
- 強烈建議除了使用 iT4300 系列的資料儲存功能外，請針對重要資料備份到另一個儲存裝置上或遠端備份，雙重備份您重要的資料。若您儲存在 iT4300 系列的資料損毀或遺失，RADION 將不負任何的責任。

感謝您使用 銳鉸科技股份有限公司 的產品。

本手冊裡的資訊在出版前雖然已經被詳細確認，但實際產品規格將已出貨時為準；任何的產品規格或相關資訊更新，請您直接上 [www.RAIDON.com.tw](http://www.RAIDON.com.tw) 網站查詢，或直接與您的業務聯絡窗口聯繫，本公司將不另行通知。

如果您對 銳鉸科技 的產品有任何疑問，或是想獲得最新產品訊息、使用手冊或軟體，請您聯絡[supporting@raidon.com.tw](mailto:supporting@raidon.com.tw)，我們將儘速回覆您。

本說明相關產品內容歸 銳鉸科技股份有限公司 版權所有

6

# RAIDON

## iT4300 Series Quick Installation Guide

### Product Diagrams and Contents of Product Package

#### Front View



- 1 HDD Tray Handle
- 2 HDD Tray Key Lock And Tray Open Button
- 3 HDD Access Indicator

#### Rear View

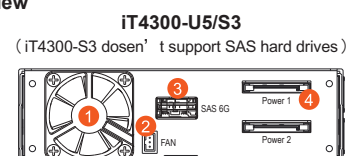

- 1 Cooling Fan
- 2 3-pin Fan Connector
- 3 SAS Connector
- 4 15-pin Power Connector

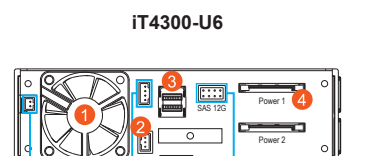

- 1 Cooling Fan
- 2 3-pin Fan Connector
- 3 SAS Connector
- 4 15-pin Power Connector
- 5 Manufacturer settings

After you open the outer package, make sure that the following items are contained in the package:

#### Contents of Product Package

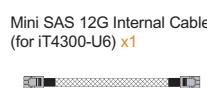
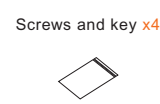

Please make sure that you do not have any damaged or in short parts. For any question, please contact to local distributor or retailer for further assistance.

v1.3 (Dec. 2017)

1

## Hardware Installation

Please follow the instructions below to complete the iT4300 series installation.

1. 解開硬碟托盤鎖。

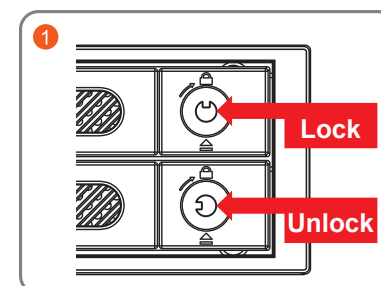

2. 按下硬碟卡榫按鍵。

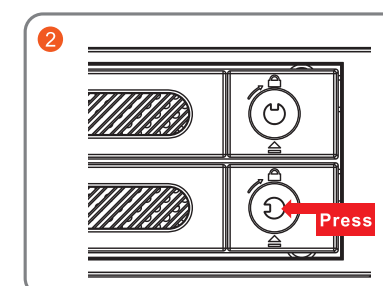

1. Unlock the hard drive tray lock.

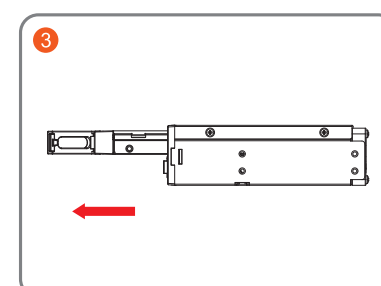

2. Press down the button for hard drive clamp.

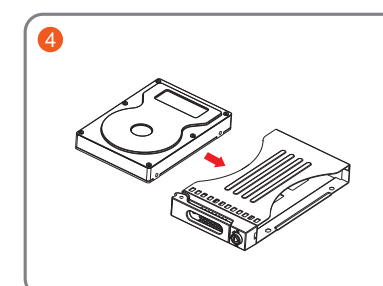

5. Secure screws from the screw kit in 4 positions.

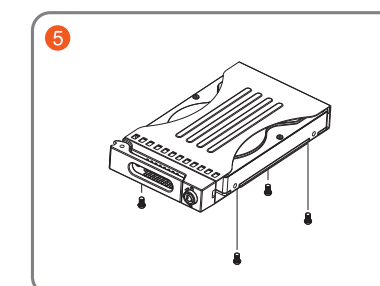

6. Refit the hard drive tray into the iT4300 series.

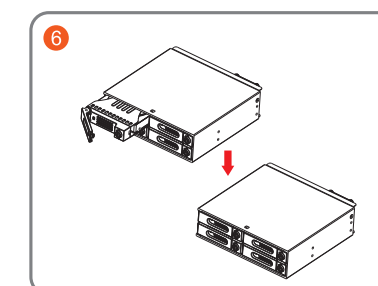

7. Install device into one of the CD-ROM bays with screws from the accessory kit. Then properly connect SATA/SAS cable and DC cable from your system to the device.

**Warning:**  
Please make sure your power cable is well connected.

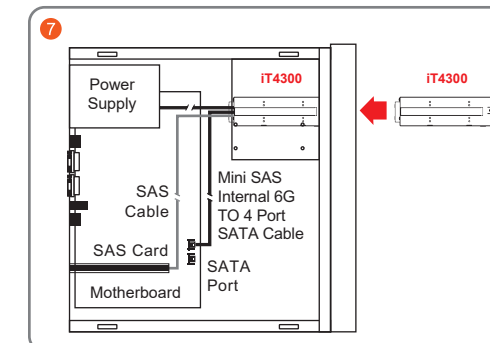

8. Power on your system after hardware installation is completed, and your operating system will automatically detect the hard drives from booting. Then follow the steps from your operating system to partition and format the drives when necessary, device will be ready to use once the format is completed.

2

3

## LED Instruction (iT4300-U5 / S3)

### When Using SAS Hard Drives (iT4300-U5/U6)

Note: While using a different SAS Interface Adapter, the LED Indication might be with a different light set.

### When Using SATA Hard Drives (iT4300-U5/U6/S3)

4

## LED Instruction (iT4300-U6)

Status	HDD Status Light	Buzzer
HDD idle	Blue light always on	--
Data access	Blue light flashing	--
HDD removed	Purple light always on	Yes
Fan failure	Blue light always on	Yes
Overheat ( $\geq 505^{\circ}\text{C}$ )	Blue light always on	Yes

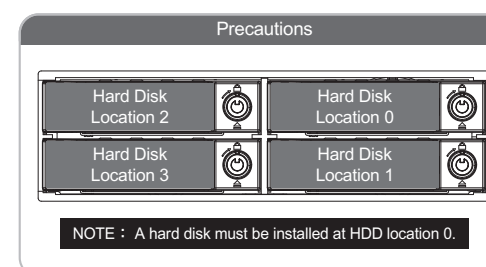

5

## Precautions Before Application

- The product allows the user to simultaneously utilize two hard drives manufactured by different companies. However, if the user expects better efficiency, we strongly recommend the users to use hard drives manufactured by the same manufacturer.
- Please ensure that the hard drives are free of bad tracks before using, otherwise, it may cause system crash in turn resulting in data loss.
- Although iT4300 Series allows you to install either SAS or SATA drives, it is recommended to check the whether mini-SAS host adapter you're using is downward compatible with SATA drives. Also note that the throughput performance may vary if SAS and SATA drive are installed.
- Whenever turning off or unplugging the iT4300 Series from your computer system becomes necessary, always remember to safely remove it from your operating system first.
- When the iT4300 Series is connected to the computer system, it's prohibited to remove, insert or swap the harddrive while data transfer is being performed.
- It is highly recommended for users to back up important data contained within the drives of the iT4300 Series on a regular basis or whenever the user feels necessary to a remote or a separate storage device. RAIDON will not be responsible for any lost of data caused during the use of the iT4300 Series or the recovery of the data lost.

Thank you for choosing this RAIDON product.  
The information provided in this manual was checked before publication, but the actual product specifications may have changed before shipping; Latest product specifications and updates can be found at [www.RAIDON.com.tw](http://www.RAIDON.com.tw) or through your sales representative. No separate notifications will be provided by our company.  
If you have any questions about RAIDON products or would like to receive the latest product information, instruction manuals, or firmware, please contact [supporting@raidon.com.tw](mailto:supporting@raidon.com.tw) for assistance.

All product-related content in this manual are copyrighted by RAIDON TECHNOLOGY, INC.

6